



Section 04
1: 200



Section 05
1: 200



Section 06
1: 200

Notes:
Do not scale from this drawing. Use figured dimensions in all cases. Verify dimensions on site and report any discrepancies to the Architect immediately. This drawing to be used in conjunction with the Architect's Specifications. © This drawing is copyright and may only be reproduced with the Architect's permission.

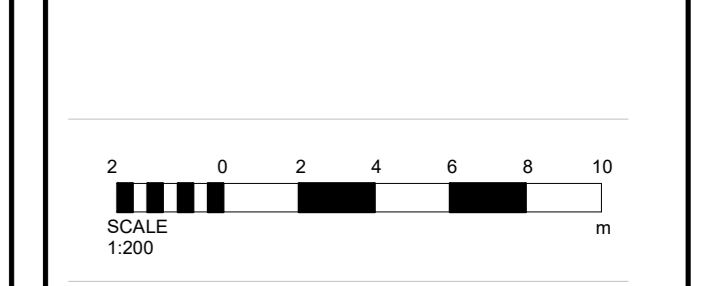
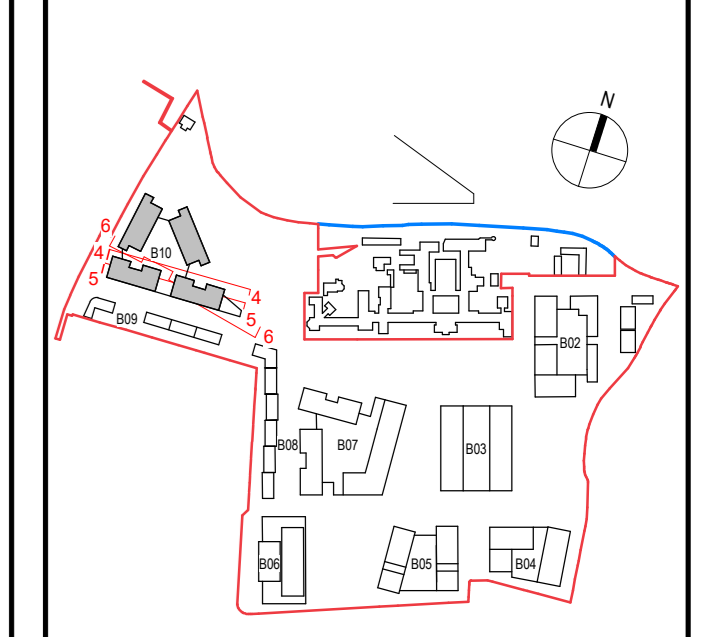

- Planning Legend**
- Site Boundary
 - Residential Entrance
 - Service Entrance
 - Crèche Entrance

- Materials Legend**
- 01 SELECTED BUFF BRICK
 - 02 SELECTED DARK BRICK
 - 03 SELECTED RED BRICK
 - 04 SELECTED METAL CAPPING
 - 05 SELECTED METAL BALCONY AND RAILING
 - 06 SELECTED DOORS AND WINDOWS

Rev.	Date	By	Check	Issue / Revision
01	Sept 2024	RP		Part 10 Planning Application
02				Details of Issue / Revision
03				Issues & Revisions



Agent Details:
Dun Laoghaire-Rathdown County Council

Agent Details:
Land Development Agency

Project Details:
Proposed Part 10 Residential Development,
Dundrum Central Development,
Dundrum Road,
Dublin 14

Drawing Title:
Block 10 - Sections - Sheet 2

Job No.	Sheet Size	Scale (A4)
P19-233D	A0_Landscape	As Indicated

Issue Date	Drawn By	Reviewed By
Sept 2024	K. Potocka	R. Quinn

Status: Purpose of Issue
P3 Part 10 Planning Application

Project	System	Spatial Zone	Level	Type	Originator	Role	Number	Revision
DCD-02-B10-ZZZ-DR-RAU-AR-3102								P3 S-1